



CITY OF HAWAIIAN GARDENS
DEPARTMENT OF COMMUNITY
DEVELOPMENT
BUILDING AND SAFETY DIVISION
 21815 Pioneer Boulevard
 Hawaiian Gardens, Ca 90716
 (562) 420 2641

B-002

**EFFECTIVE :
1-05-2015**

MASONRY WALL DETAILS (UP TO 6' HIGH)

This information bulletin provides general information and guidance for the construction of masonry walls not more than 6 feet high. A building permit shall be obtained for concrete masonry walls over 3'-0" high. Masonry walls over 6 feet high shall be engineered and requires further plan review by building division. Fences shall comply with City's Zoning Code regardless whether a permit is required or not.

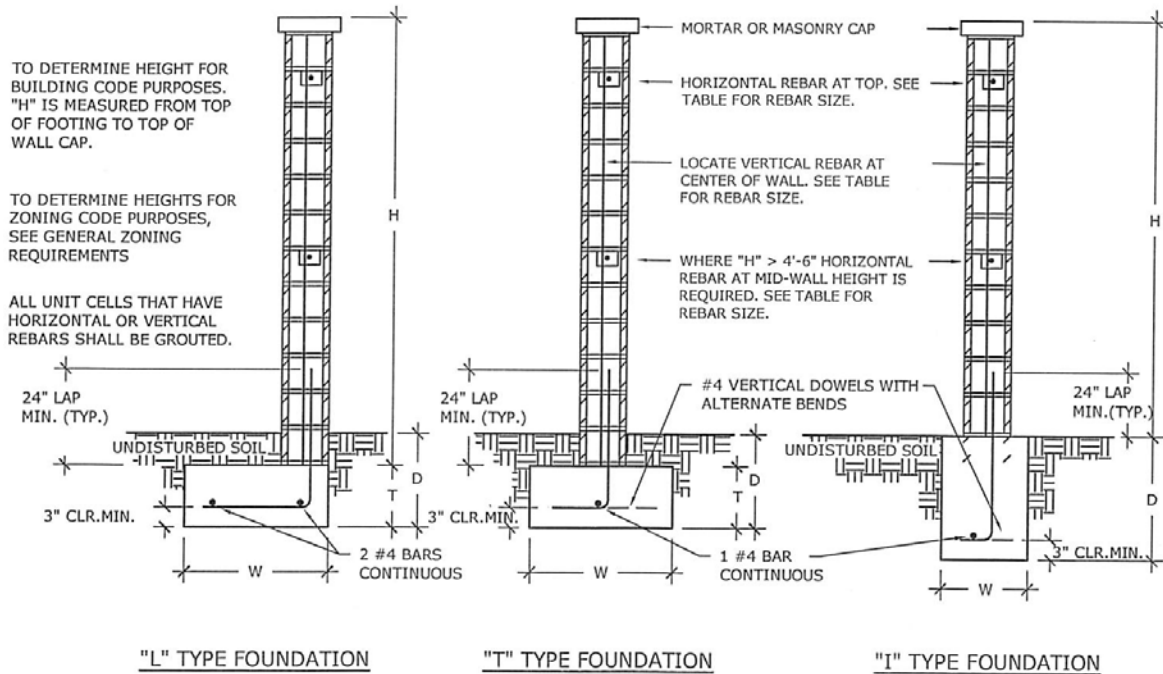

| WALL HEIGHT | "L" TYPE FOUNDATION | | | "T" TYPE FOUNDATION | | | "I" TYPE FOUNDATION | | VERTICAL REBAR | HORIZONTAL REBAR |
|-------------|---------------------|-----|-----|---------------------|-----|----|---------------------|-----|---------------------|------------------|
| | W | D | T | W | D | T | W | D | | |
| 3'-6" | 18" | 18" | 9" | 14" | 12" | 6" | 12" | 22" | #4 REBAR @ 48" O.C. | #4 REBAR |
| 4'-0" | 24" | 18" | 9" | 18" | 12" | 6" | 12" | 26" | #4 REBAR @ 48" O.C. | #4 REBAR |
| 5'-0" | 30" | 24" | 12" | 24" | 12" | 9" | 12" | 30" | #4 REBAR @ 48" O.C. | #4 REBAR |
| 6'-0" | 36" | 24" | 12" | 26" | 14" | 9" | 12" | 36" | #4 REBAR @ 24" O.C. | #4 REBAR |

GENERAL ZONING REQUIREMENTS

The height of fences shall be measured from the sidewalk adjoining the fence or from the average grade of both sides of the fence between two private properties. Walls located in the required front yard setback shall be a minimum height of 36” and a maximum height of 42”. Walls on the other portions of the lot shall be a maximum height of 6’-0”. Please contact the Planning Division for further information and obtain required approvals prior erecting a fence.

COMMON PROPERTY LINE WALL

Where a wall is requested to be placed along or across a property line between neighbors, a completed “Common Property Line Wall Agreement and Maintenance” form signed by all of the common property owners is required prior to permit issuance. Where a wall is proposed to be located on only one property, but is located near a property line and no “Common Property Line Wall Agreement and Maintenance” form is provided, a survey of the property by a licensed land surveyor will be required to show that the wall is located entirely on the owner’s property.

**REQUIRED INSPECTIONS WHERE A PERMIT ISSUED FOR CMU FENCES
OVER 3’ HIGH BUT NO MORE THAN 6’ HIGH**

| | |
|---|--|
| LOCATION INSPECTION | When trench is ready for concrete. Where applicable, Common Property Line Wall Agreement and Maintenance Form or Survey Certification shall be required. |
| FINAL INSPECTION TO MEASURE THE HEIGHT OF THE FENCE | When the wall is grouted and cap is installed. |

Where a permit required this form shall be attached to the site plan showing the location of the proposed fence prior permit issuance.